

STEEL CABLE TRAY

LADDER | VENTILATED | SOLID | INSTRUMENTATION CHANNEL

548 Nicola Place
Port Coquitlam, BC V3B 0K4
Canada

Direct Tel: 604-942-0050
Main Tel: 604-540-0011
Toll Free: 1-888-222-2633

Email: sales@codeelectric.com
orderentry@codeelectric.com

www.codeelectric.com

STRAIGHT LENGTH

Pg. 112-114

VENTILATED



FITTINGS

Pg. 115-132

ELBOW



OUTSIDE/INSIDE VERTICAL RISER



TEE



CROSS



REDUCER



ACCESSORIES - COVERS

Pg. 213

FLAT



PEAKED



LOUVERED

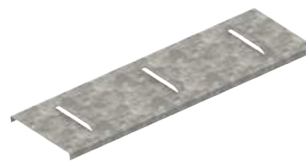

CUSTOM



ACCESSORIES - HARDWARE

Pg. 214-222

ADJUSTABLE RISER



END PLATES



CUSTOM FITTINGS

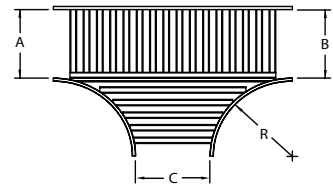

STEEL - VENTILATED - STRAIGHT LENGTH

CSA CLASS C

Trays are constructed from pre-galvanize steel.



VENTILATED			
Rung Spacing		Width	
cm	in	cm (W)	in
5	2	15	6
		30	12
		45	18
		60	24
		75	30
		90	36

HOW TO ORDER - EXAMPLE: SVC-30			
Steel	Ventilated	Class	Width
S	V	C	30
S	V	C6	30

*Length in 3 meters

*Imperial measurements are for reference only
*Custom width available on request

*Max 50mm / 2" spacing between rungs

		CSA C22.2 #126.1-98	
		Span, m (ft)	Load kg/m (lb/ft)
SVC		3 m (10 ft)	97 kg/m (65 lb/ft)
SVC6			

SPYDERLOK

The original quick connector included with all fittings and tray.

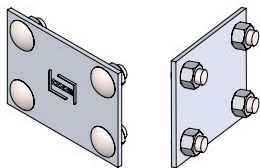

RUNG PROFILE

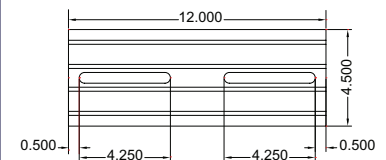
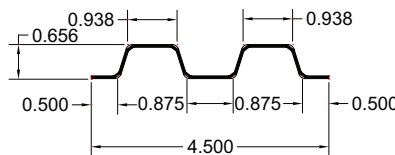

STEEL - VENTILATED - STRAIGHT LENGTH

CSA CLASS D

Trays are constructed from pre-galvanize steel.



VENTILATED			
Rung Spacing		Width	
cm	in	cm (W)	in
5	2	15	6
		30	12
		45	18
		60	24
		75	30
		90	36

HOW TO ORDER - EXAMPLE: SVD6-30			
Steel	Ventilated	Class	Width
S	V	D	30
S	V	D6	30

*Available in 3 meter lengths

*Imperial measurements are for reference only
*Custom width available on request

*Max 50mm / 2" spacing between rungs

		CSA C22.2 #126.1-98	
		Span, m (ft)	Load kg/m (lb/ft)
SVD		3 m (10 ft)	179 kg/m (120 lb/ft)
SVD6			

SPYDERLOK

The original quick connector included with all fittings and tray.

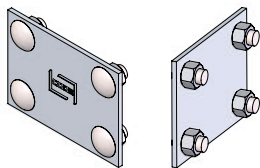

RUNG PROFILE

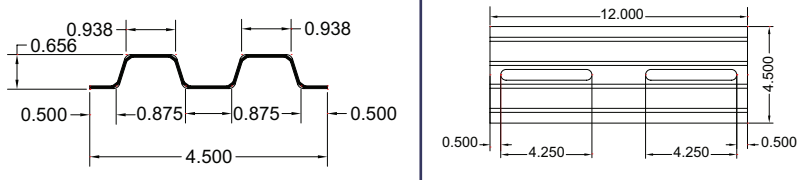

STEEL - VENTILATED - STRAIGHT LENGTH

CSA CLASS E

Trays are constructed from pre-galvanize steel.



VENTILATED			
Rung Spacing		Width	
cm	in	cm (W)	in
5	2	15	6
		30	12
		45	18
		60	24
		75	30
		90	36

HOW TO ORDER - EXAMPLE: SVE-30			
Steel	Ventilated	Class	Width
S	V	E	30
S	V	E6	30

*Length in 3 meters

*Imperial measurements are for reference only
*Custom width available on request

*Max 50mm / 2" spacing between rungs

		CSA C22.2 #126.1-98	
		Span, m (ft)	Load kg/m (lb/ft)
SVE		3 m (10 ft)	299 kg/m (200 lb/ft)
SVE6		3 m (10 ft)	299 kg/m (200 lb/ft)

SPYDERLOK

The original quick connector included with all fittings and tray.

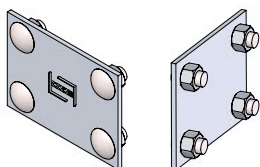

RUNG PROFILE

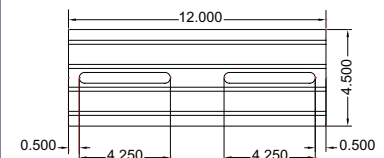
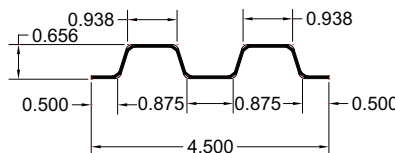

STEEL - VENTILATED - HORIZONTAL ELBOW FITTING

Fittings are used to change the size or direction of the cable tray. Material: pre-galvanized steel.

HOW TO ORDER - EXAMPLE:				SEV90-102-30-60					
Material	Fitting Type	Style	Degree	Side Rail (H)		Width (W)		Radius (R)	
				mm	in	cm	in	cm	in
S	E	V	30	102	(4")	15	(6")	30	(12")
			45			30	(12")		
			60			45	(18")		
			60			60	(24")		
			90			75	(30")		
			90	90	(36")	(36")			

*Imperial measurements are for reference only

DEGREES

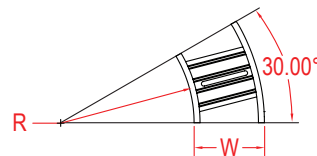
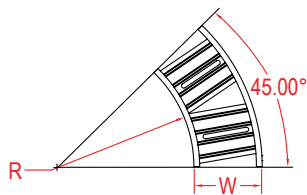
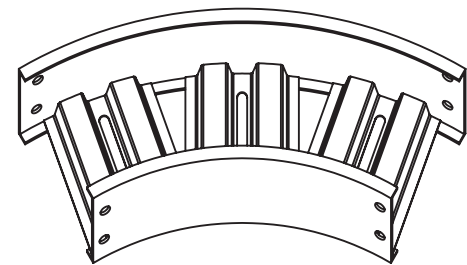
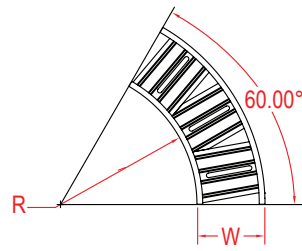
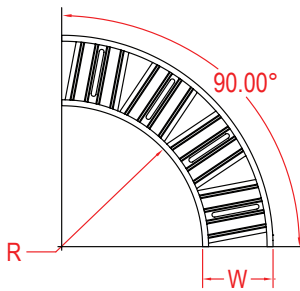

SPYDERLOK

The original quick connector included with all fittings and tray.

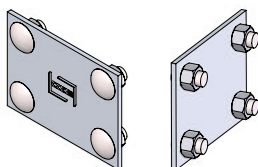

RUNG PROFILE

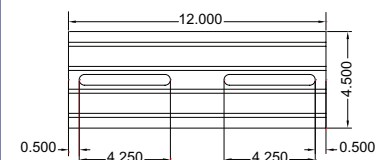
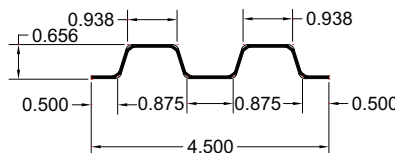

STEEL - VENTILATED - HORIZONTAL ELBOW FITTING

Fittings are used to change the size or direction of the cable tray. Material: pre-galvanized steel.

HOW TO ORDER - EXAMPLE:				SEV90-115-30-60					
Material	Fitting Type	Style	Degree	Side Rail (H)		Width (W)		Radius (R)	
				mm	in	cm	in	cm	in
S	E	V	30	115	(4 1/2")	15	(6")	30	(12")
			45			30	(12")		
			60			45	(18")		
			60			60	(24")		
			90			75	(30")		
			90	90	(36")				

*Imperial measurements are for reference only

DEGREES

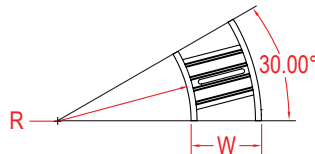
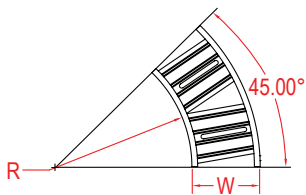
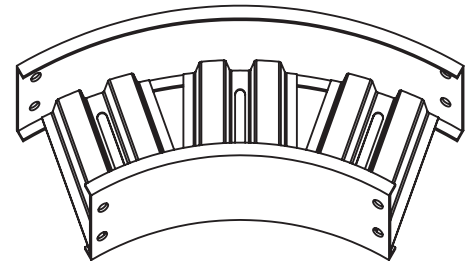
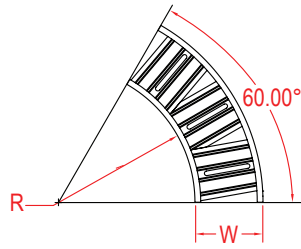
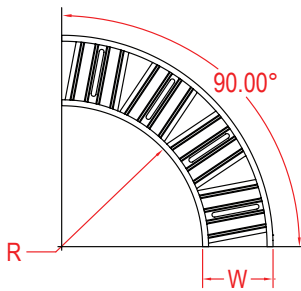

SPYDERLOK

The original quick connector included with all fittings and tray.

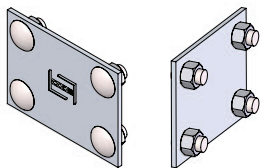

RUNG PROFILE

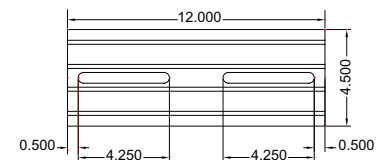
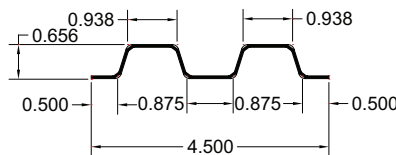

STEEL - VENTILATED - HORIZONTAL ELBOW FITTING

Fittings are used to change the size or direction of the cable tray. Material: pre-galvanized steel.

HOW TO ORDER - EXAMPLE:				SEV90-150-30-60					
Material	Fitting Type	Style	Degree	Side Rail (H)		Width (W)		Radius (R)	
				mm	in	cm	in	cm	in
S	E	V	30	150	(6")	15	(6")	30	(12")
			45			30	(12")		
			60			45	(18")		
			60			60	(24")		
			90			75	(30")		
			90	90	(36")				

*Imperial measurements are for reference only

DEGREES

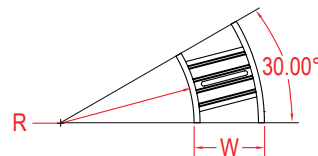
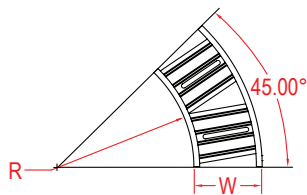
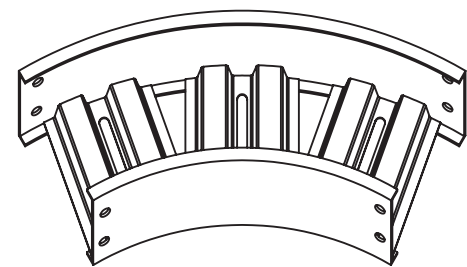
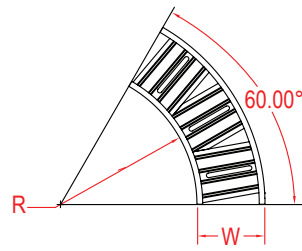
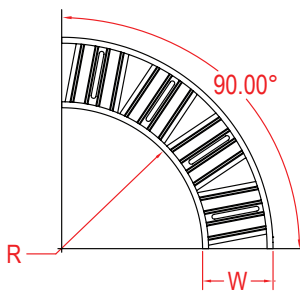

SPYDERLOK

The original quick connector included with all fittings and tray.

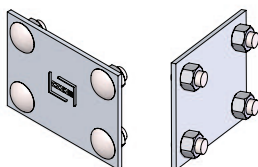

RUNG PROFILE

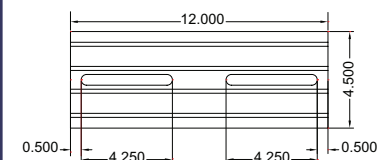
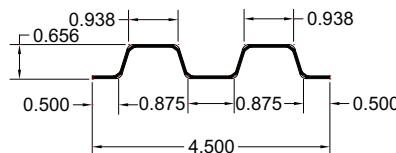

STEEL - VENTILATED - OUTSIDE VERTICAL RISER FITTING

Fittings are used to change the size or direction of the cable tray. Material: pre-galvanized steel.

HOW TO ORDER - EXAMPLE:				SOVV90-102-30-60					
Material	Fitting Type	Style	Degree	Side Rail (H)		Width (W)		Radius (R)	
				mm	in	cm	in	cm	in
S	OV	V	30	102	(4")	15	(6")	30	(12")
			45			30	(12")		
			60			45	(18")		
			60			60	(24")		
			90			75	(30")		
					90	(36")	90	(36")	

*Imperial measurements are for reference only

DEGREES

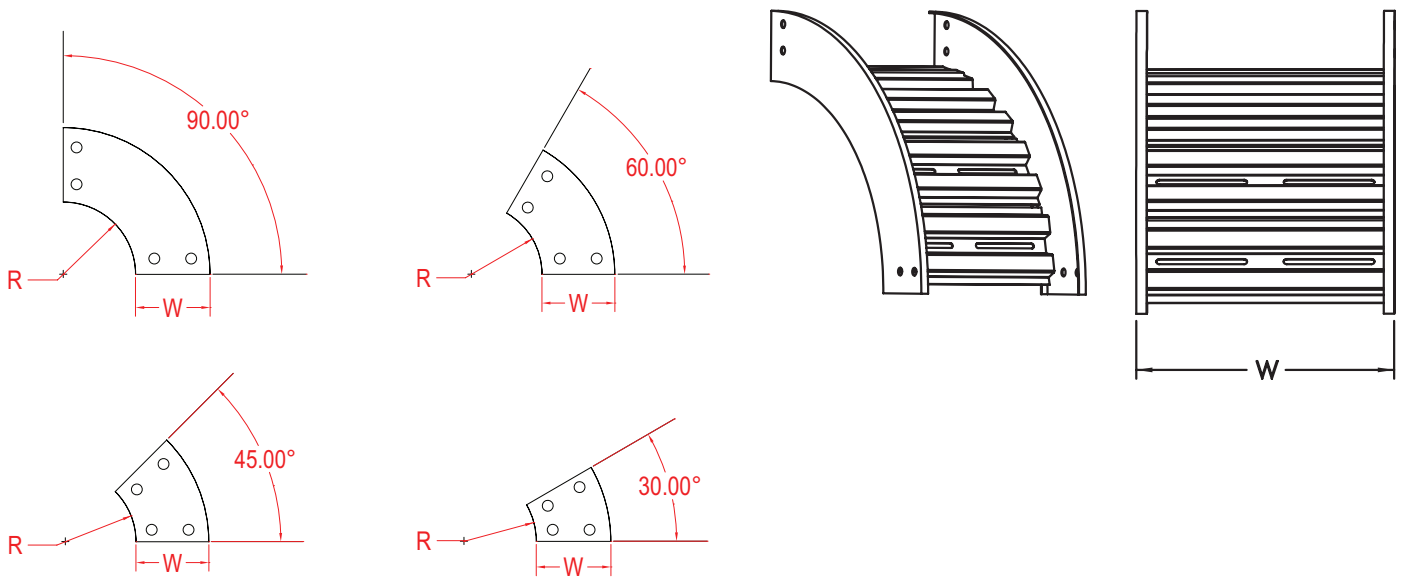

SPYDERLOK

The original quick connector included with all fittings and tray.

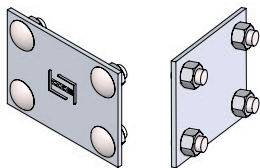

RUNG PROFILE

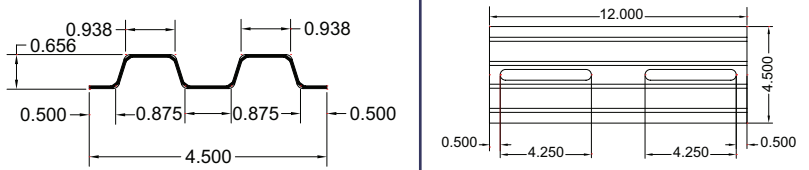

STEEL - VENTILATED - OUTSIDE VERTICAL RISER FITTING

Fittings are used to change the size or direction of the cable tray. Material: pre-galvanized steel.

HOW TO ORDER - EXAMPLE:				SOVV90-115-30-60					
Material	Fitting Type	Style	Degree	Side Rail (H)		Width (W)		Radius (R)	
				mm	in	cm	in	cm	in
S	OV	V	30	115	(4 1/2")	15	(6")	30	(12")
			45			30	(12")		
			60			45	(18")		
			60			60	(24")		
			90			75	(30")		
			90	90	(36")				

*Imperial measurements are for reference only

DEGREES

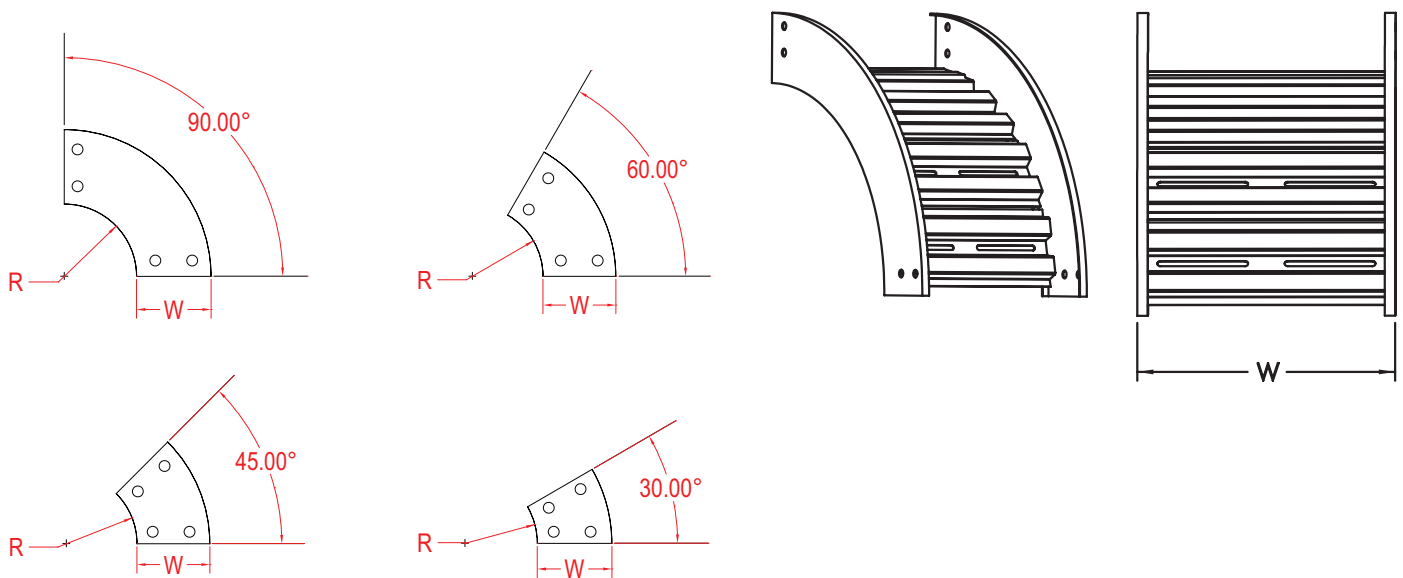

SPYDERLOK

The original quick connector included with all fittings and tray.

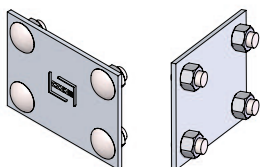

RUNG PROFILE

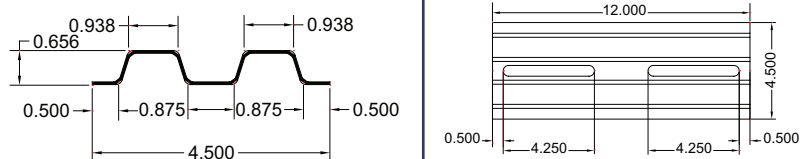

STEEL - VENTILATED - OUTSIDE VERTICAL RISER FITTING

Fittings are used to change the size or direction of the cable tray. Material: pre-galvanized steel.

HOW TO ORDER - EXAMPLE:				SOVV90-150-30-60					
Material	Fitting Type	Style	Degree	Side Rail (H)		Width (W)		Radius (R)	
				mm	in	cm	in	cm	in
S	OV	V	30	150	(6")	15	(6")	30	(12")
			45			30	(12")		
			60			45	(18")		
			90			60	(24")		
						75	(30")		
	90	(36")	90	(36")					

*Imperial measurements are for reference only

DEGREES

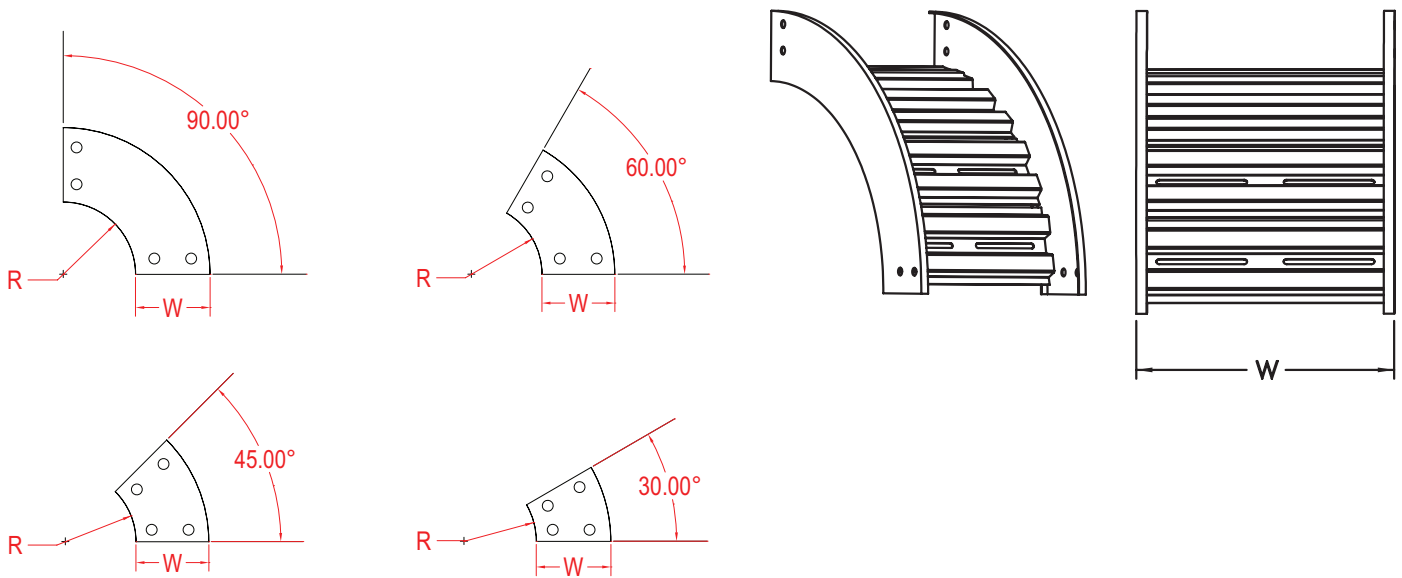

SPYDERLOK

The original quick connector included with all fittings and tray.

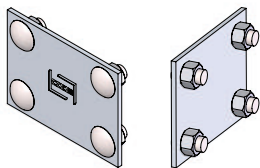

RUNG PROFILE

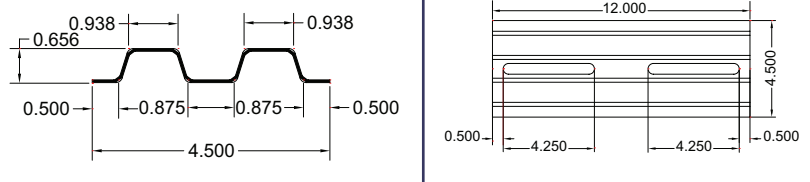

STEEL - VENTILATED - INSIDE VERTICAL RISER FITTING

Fittings are used to change the size or direction of the cable tray. Material: pre-galvanized steel.

HOW TO ORDER - EXAMPLE:				SIVV90-102-30-60					
Material	Fitting Type	Style	Degree	Side Rail (H)		Width (W)		Radius (R)	
				mm	in	cm	in	cm	in
S	IV	V	30	102	(4")	15	(6")	30	(12")
			45			30	(12")		
			60			45	(18")		
			60			60	(24")		
			90			75	(30")		
			90	90	(36")	(36")			

*Imperial measurements are for reference only

DEGREES

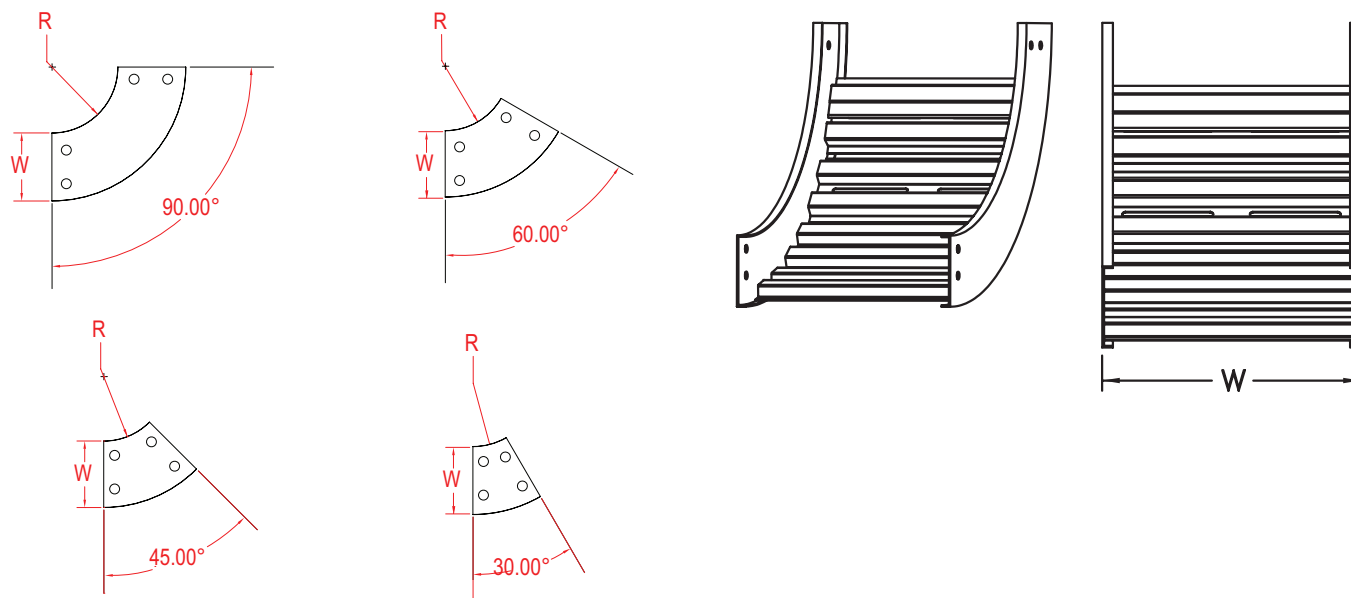

SPYDERLOK

The original quick connector included with all fittings and tray.

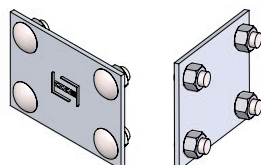

RUNG PROFILE

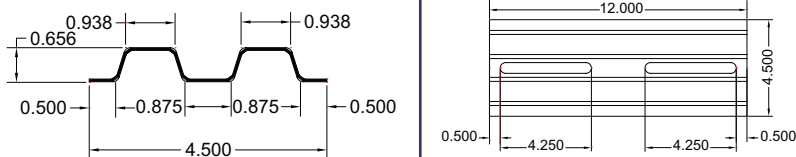

STEEL - VENTILATED - INSIDE VERTICAL RISER FITTING

Fittings are used to change the size or direction of the cable tray. Material: pre-galvanized steel.

HOW TO ORDER - EXAMPLE:				SIVV90-115-30-60					
Material	Fitting Type	Style	Degree	Side Rail (H)		Width (W)		Radius (R)	
				mm	in	cm	in	cm	in
S	IV	V	30	115	(4 1/2")	15	(6")	30	(12")
			45			30	(12")		
			60			45	(18")		
			60			60	(24")		
			90			75	(30")		
			90	90	(36")	(36")			

*Imperial measurements are for reference only

DEGREES

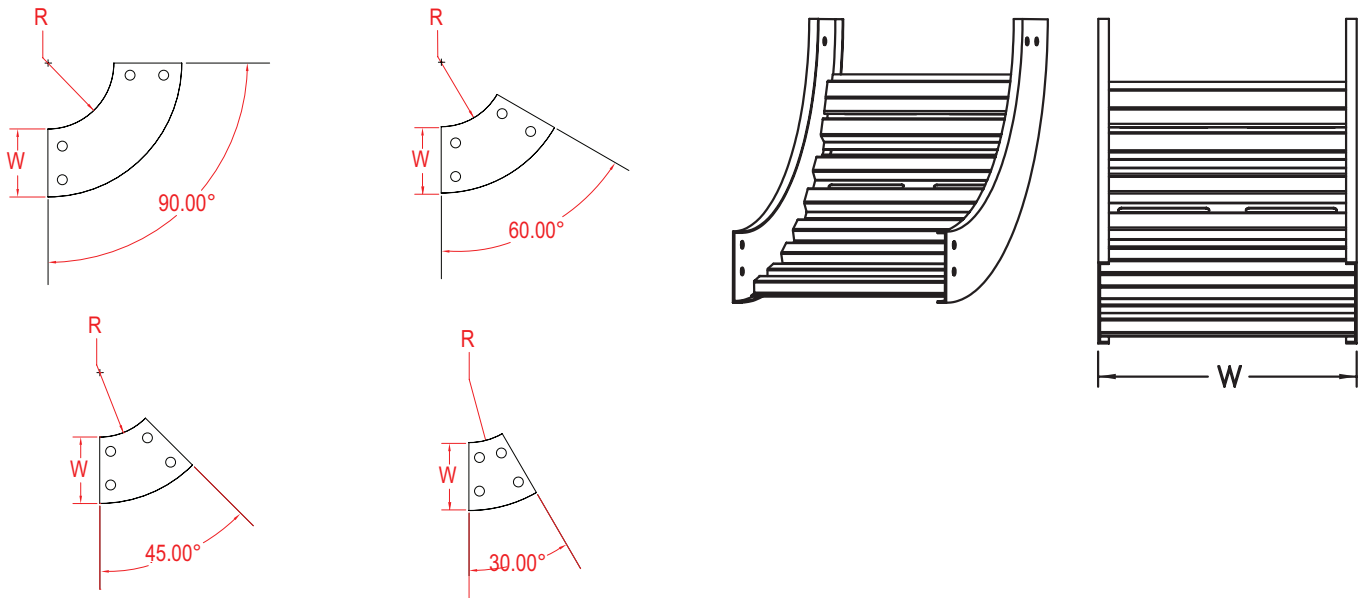

SPYDERLOK

The original quick connector included with all fittings and tray.

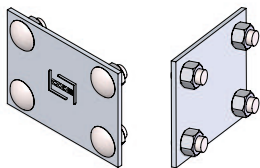

RUNG PROFILE

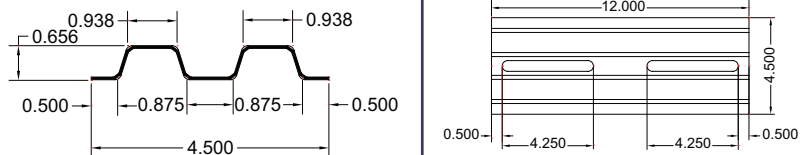

STEEL - VENTILATED - INSIDE VERTICAL RISER FITTING

Fittings are used to change the size or direction of the cable tray. Material: pre-galvanized steel.

HOW TO ORDER - EXAMPLE:				SIVV90-150-30-60					
Material	Fitting Type	Style	Degree	Side Rail (H)		Width (W)		Radius (R)	
				mm	in	cm	in	cm	in
S	IV	V	30	150	(6")	15	(6")	30	(12")
			45			30	(12")		
			60			45	(18")		
			60			60	(24")		
			90			75	(30")		
			90	90	(36")				

*Imperial measurements are for reference only

DEGREES

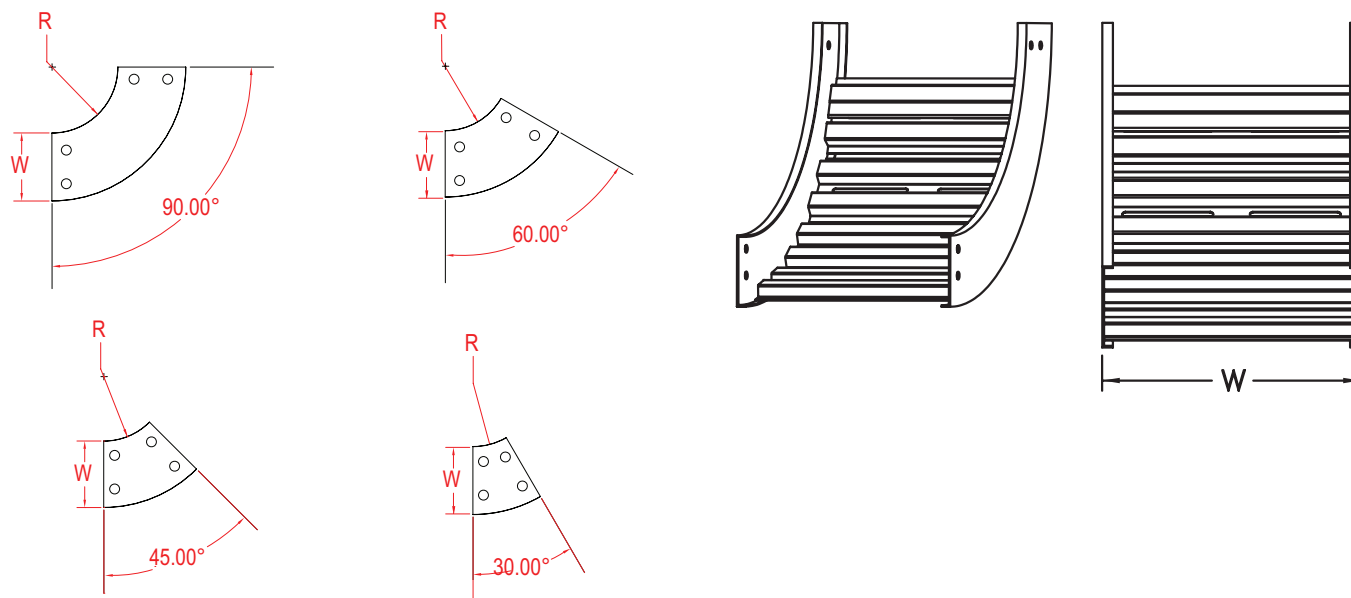

SPYDERLOK

The original quick connector included with all fittings and tray.

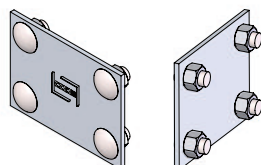

RUNG PROFILE

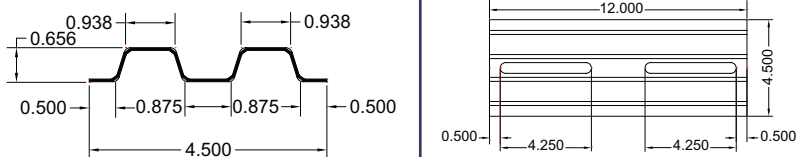

STEEL - VENTILATED - HORIZONTAL TEE FITTINGS

Fittings are used to change the size or direction of the cable tray. Material: pre-galvanized steel.

HOW TO ORDER - EXAMPLE:			STV-102-30-60					
Material	Fitting Type	Style	Side Rail (H)		Width (W)		Radius (R)	
			mm	in	cm	in	cm	in
S	T	V	102	(4")	15	(6")	30	(12")
					30	(12")		
					45	(18")		
					60	(24")		
					75	(30")		
					90	(36")		

*Imperial measurements are for reference only

TEE

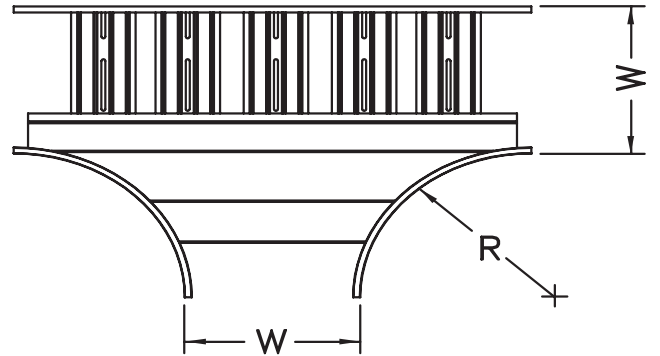
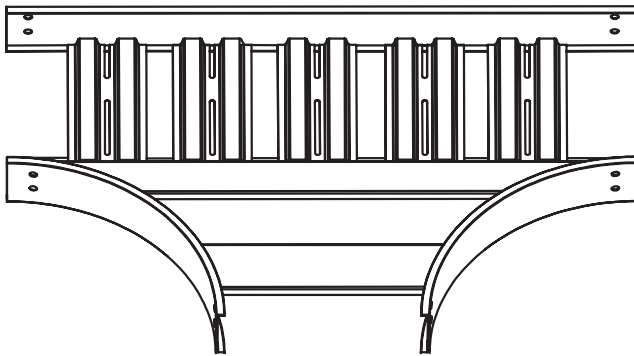

SPYDERLOK

The original quick connector included with all fittings and tray.

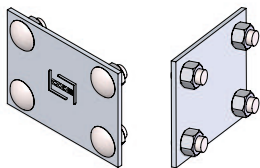

RUNG PROFILE

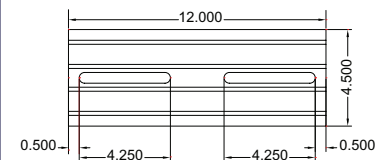
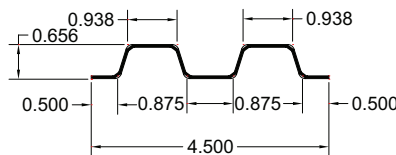

STEEL - VENTILATED - HORIZONTAL TEE FITTINGS

Fittings are used to change the size or direction of the cable tray. Material: pre-galvanized steel.

HOW TO ORDER - EXAMPLE:			STV-115-30-60					
Material	Fitting Type	Style	Side Rail (H)		Width (W)		Radius (R)	
			mm	in	cm	in	cm	in
S	T	V	115	(4 1/2")	15	(6")	30	(12")
					30	(12")		
					45	(18")		
					60	(24")		
					75	(30")		
					90	(36")		

*Imperial measurements are for reference only

TEE

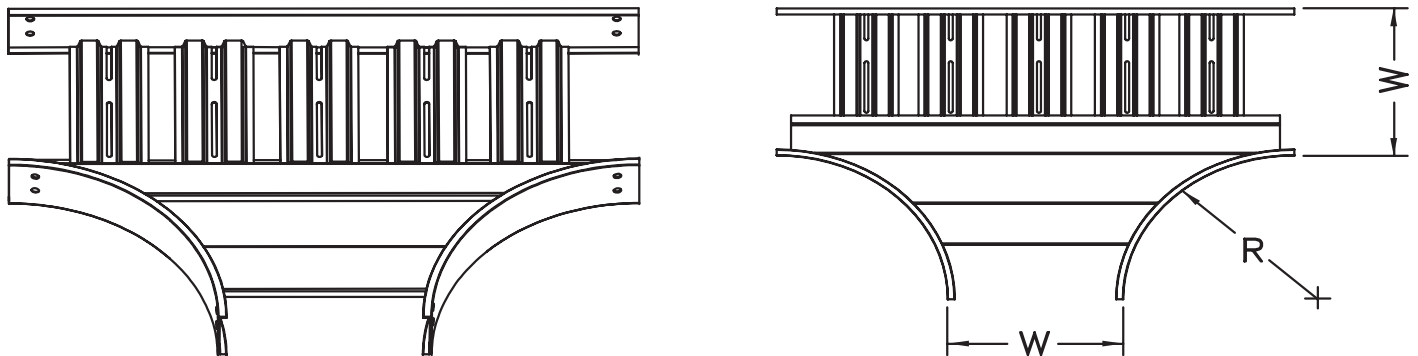

SPYDERLOK

The original quick connector included with all fittings and tray.

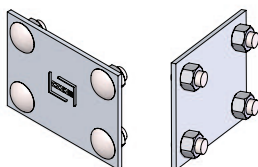

RUNG PROFILE

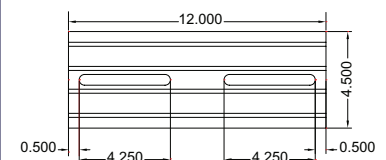
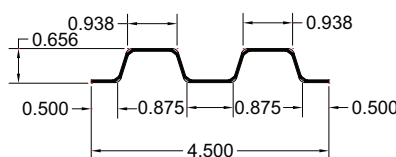

STEEL - VENTILATED - HORIZONTAL TEE FITTINGS

Fittings are used to change the size or direction of the cable tray. Material: pre-galvanized steel.

HOW TO ORDER - EXAMPLE:			STV-150-30-60					
Material	Fitting Type	Style	Side Rail (H)		Width (W)		Radius (R)	
			mm	in	cm	in	cm	in
S	T	V	150	(6")	15	(6")	30	(12")
					30	(12")		
					45	(18")		
					60	(24")		
					75	(30")		
					90	(36")		

*Imperial measurements are for reference only

TEE

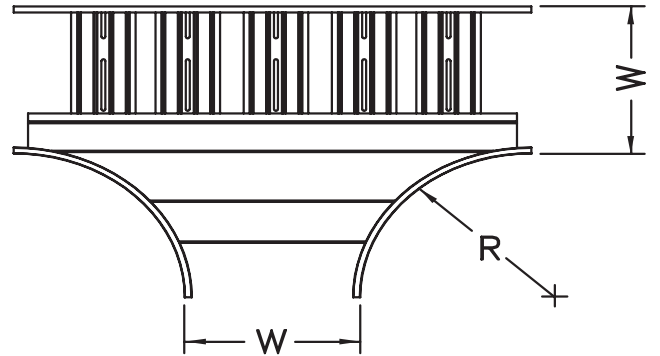
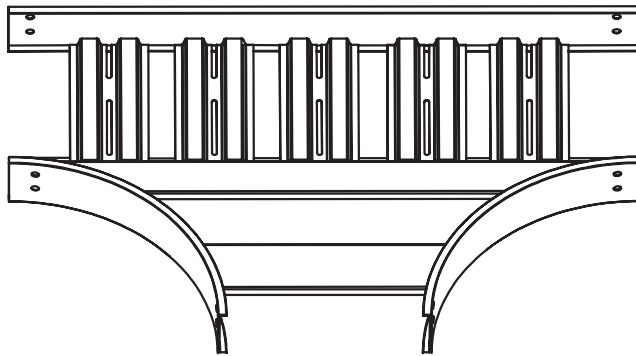

SPYDERLOK

The original quick connector included with all fittings and tray.

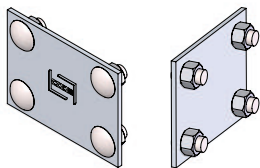

RUNG PROFILE

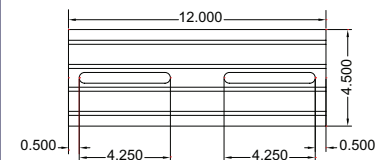
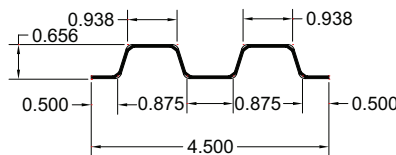

STEEL - VENTILATED - HORIZONTAL CROSS FITTINGS

Fittings are used to change the size or direction of the cable tray. Material: pre-galvanized steel.

HOW TO ORDER - EXAMPLE:			SXV-102-30-60					
Material	Fitting Type	Style	Side Rail (H)		Width (W)		Radius (R)	
			mm	in	cm	in	cm	in
S	X	V	102	(4")	15	(6")	30	(12")
					30	(12")		
					45	(18")		
					60	(24")		
					75	(30")		
					90	(36")		

*Imperial measurements are for reference only

CROSS

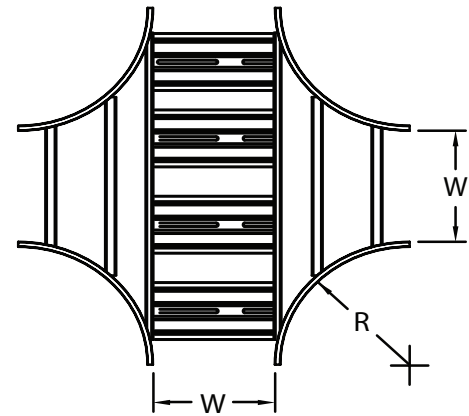
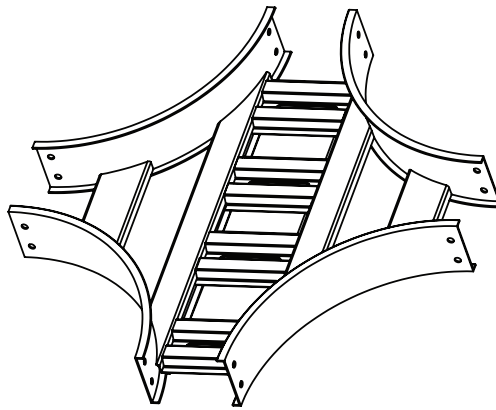

SPYDERLOK

The original quick connector included with all fittings and tray.

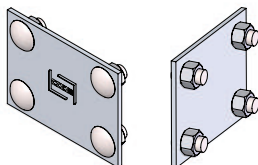

RUNG PROFILE

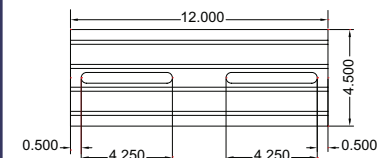
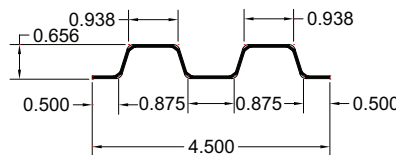

STEEL - VENTILATED - HORIZONTAL CROSS FITTINGS

Fittings are used to change the size or direction of the cable tray. Material: pre-galvanized steel.

HOW TO ORDER - EXAMPLE:			SXV-115-30-60					
Material	Fitting Type	Style	Side Rail (H)		Width (W)		Radius (R)	
			mm	in	cm	in	cm	in
S	X	V	115	(4 1/2")	15	(6")	30	(12")
					30	(12")		
					45	(18")		
					60	(24")		
					75	(30")		
					90	(36")		

*Imperial measurements are for reference only

CROSS

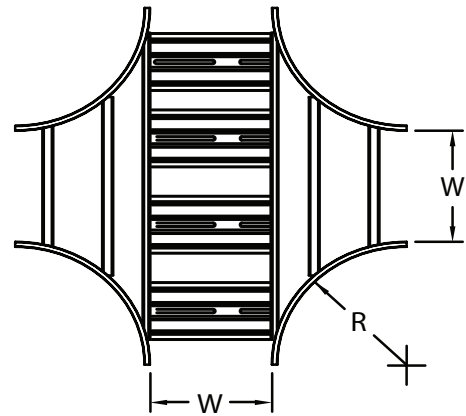
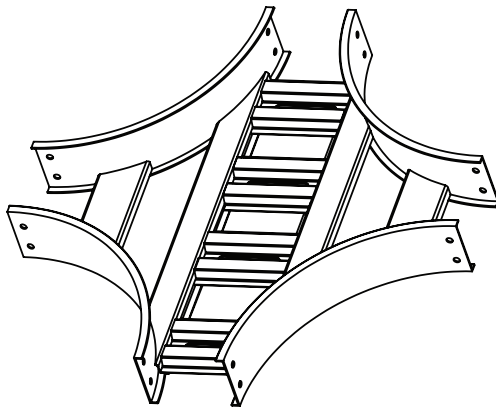

SPYDERLOK

The original quick connector included with all fittings and tray.

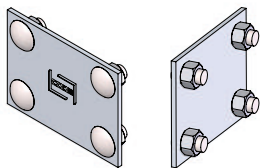

RUNG PROFILE

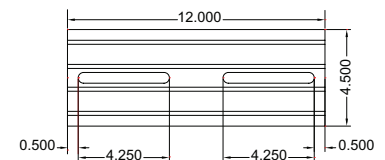
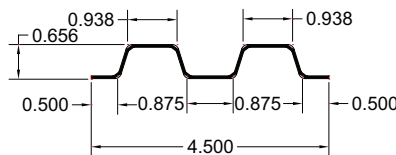

STEEL - VENTILATED - HORIZONTAL CROSS FITTINGS

Fittings are used to change the size or direction of the cable tray. Material: pre-galvanized steel.

HOW TO ORDER - EXAMPLE:			SXV-150-30-60					
Material	Fitting Type	Style	Side Rail (H)		Width (W)		Radius (R)	
			mm	in	cm	in	cm	in
S	X	V	150	(6")	15	(6")	30	(12")
					30	(12")		
					45	(18")		
					60	(24")		
					75	(30")		
					90	(36")		

*Imperial measurements are for reference only

CROSS

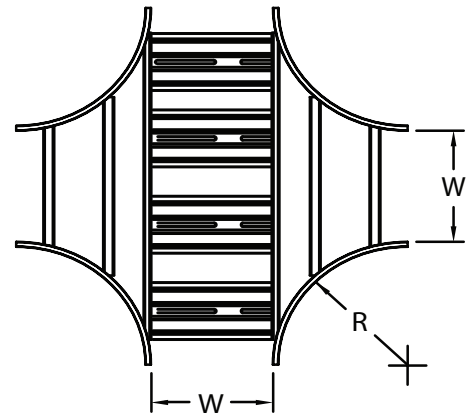
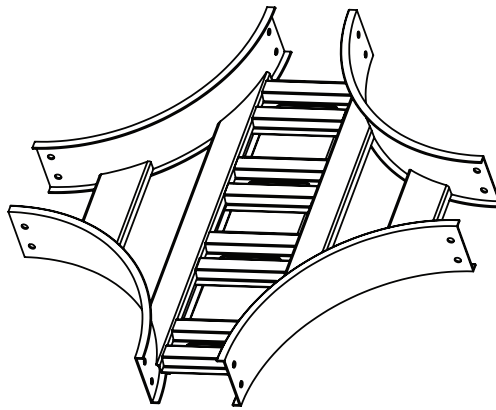

SPYDERLOK

The original quick connector included with all fittings and tray.

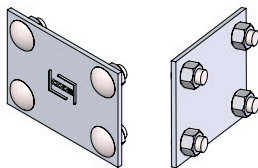

RUNG PROFILE

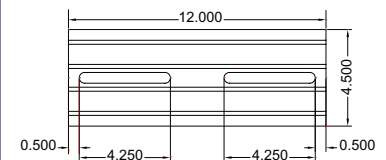
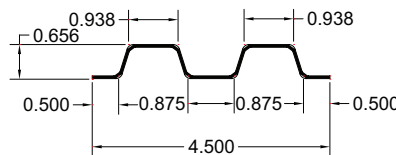

STEEL - FITTINGS - WYE

WYE fittings are available in right hand or left hand styles.

Material	Reducer	Style	Class	Side Rail (H)		Direction	Width (A)		Width (B)		Width (C)		Radius (R)
				cm	in		cm	in	cm	in	cm	in	
S	W	L V or S	C D or E	102	(4")	L or R	15	(6")	15	(6")	15	(6")	30 45
				115	(4 1/2")		30	(12")	30	(12")	30	(12")	
				150	(6")		45	(18")	45	(18")	45	(18")	
							60	(24")	60	(24")	60	(24")	
							75	(30")	75	(30")	75	(30")	
							90	(36")	90	(36")	90	(36")	

*Imperial measurements are for reference only

*Class Reference corresponds with Side Rail and only required for solid orders

*Width (A) and Width (B) correspond together

*Width (B) provides a range of measurements in centimeters and inches

FITTING

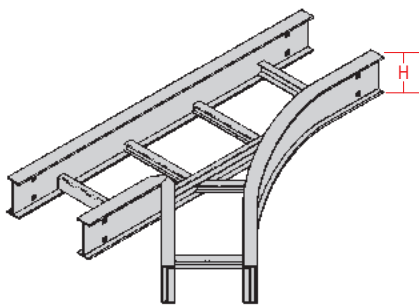

C Shaped Profile

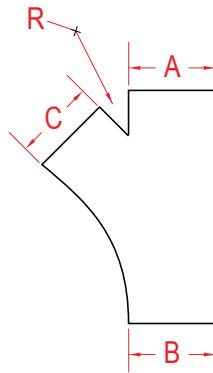

Left WYE Reducer (WL)

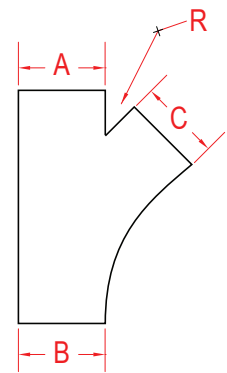

Right WYE Reducer (WR)

SPYDERLOK

The original quick connector included with all fittings and tray.

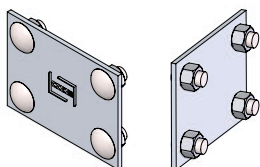

STEEL - FITTINGS - VERTICAL TEE

Vertical Tees are available in up or down styles.

Material	Reducer	Style	Class	Side Rail (H)		Direction	Width (W)		Radius (R)
				cm	in		cm	in	
S	VT	L, V, or S	C, D, or E	102	(4")	U or D	15	(6")	30
				115	(4 1/2")		30	(12")	
				150	(6")		45	(18")	
							60	(24")	
							75	(30")	
						90	(36")		

*Imperial measurements are for reference only

*Class Reference corresponds with Side Rail and only required for solid orders

*Width (A) and Width (B) correspond together

*Width (B) provides a range of measurements in centimeters and inches

FITTING

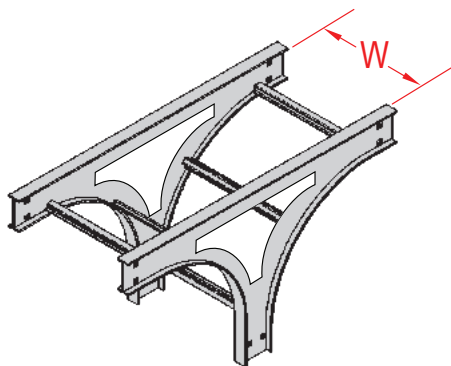

C Shaped Profile

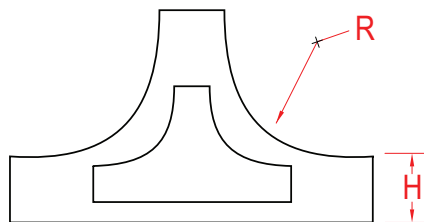

Up "T" Reducer
(VTU)

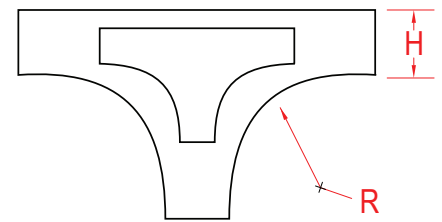

Down "T" Reducer
(VTD)

SPYDERLOK

The original quick connector included with all fittings and tray.

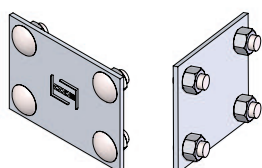

STEEL - FITTINGS - REDUCER

Fitting reducers are available in right hand, left hand or concentric styles. CODE Manufacturing strongly recommends the use of offset or concentric reducers which provide cost savings and are easier to install while doing the same job.

Material	Reducer	Style	Solid Class Reference	Side Rail (H)		Width (A)		Width (B)		
				cm	in	cm	in	cm	in	
S	RL	L, V, or S	C	102	(4")	30	(12")	15	(6")	
	RC		D or E	115	(4 1/2")	45	(18")	30	(12")	
	RR		C6, D6, or E6	150	(6")	60	(24")	45	(18")	
							75	(30")	60	(24")
							90	(36")	90	(30")

**Imperial measurements are for reference only*
**Class Reference corresponds with Side Rail and only required for solid orders*
**Width (A) and Width (B) correspond together*
**Width (B) provides a range of measurements in centimeters and inches*

FITTING

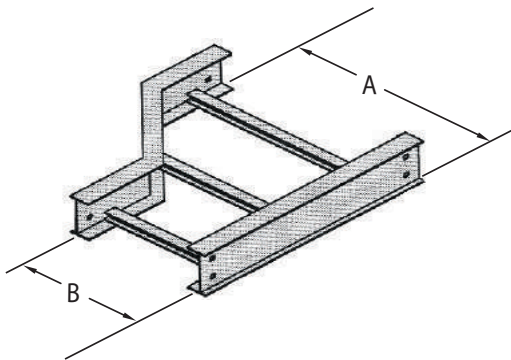

Left Reducer
(RL)

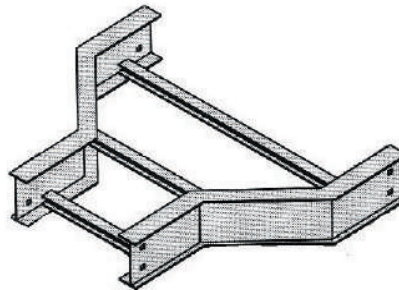

Center Reducer
(RC)

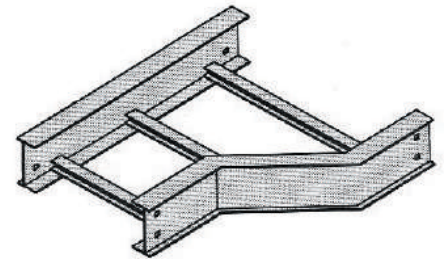

Right Reducer
(RR)

SPYDERLOK

The original quick connector included with all fittings and tray.

